

TARTAN[®] 4700

YACHTS

Specifications and Features



Tartan 4700 | Specifications & Features

Sophisticated Designs • Exceptional Performance • Superior Value

At Tartan Yachts we have a passion to deliver the best sailboat owner experience possible. Our commitment to design and engineering is based on total performance. We don't believe that a simple superficial appeal to aesthetics is enough to serve the interests of our owners. Our designers, builders and sales team understand and appreciate that every yacht we build must be the best yacht we build. Most importantly we are committed to the next 50 years with the focus of simply making our customer experience the best the industry has to offer.

Hull

- NPG Isophthalic gelcoat
- Infused epoxy modified vinylester hull
 - Locally reinforced at high load areas
 - Closed cell synthetic foam hull coring
- Resin infused hull laminated in "one shot" eliminating secondary bonding of structural materials
- Interior surfaces painted out with enamel gelcoat for aesthetics
- Internal structural grid designed to carry rig and keel loads, glass taped into hull
- UL and ABS approved, corrosion free Marelon flush thru hull fittings
 - All hull penetrations made into solid fiberglass "core windows"
- Built to meet ABS Plan Certification
- Transferrable 15-year hull structural and blister warranty

Deck

- NPG Isophthalic gelcoat
- Infused epoxy modified vinylester deck
- CNC computer cut sealed end grain balsa coring
- Locally reinforced at high load areas
- Molded nonskid surface on working areas
- All deck penetrations made into solid fiberglass "core windows"
- 6061 T6 aluminum backing plates added at lamination for all loaded hardware
- Inward facing hull flange with integrally molded 6061 T6 aluminum bar forming a full length backing plate for hull to deck joint
- Hull to deck joint fasteners, stainless steel to meet or exceed ABS standard for offshore use
- Hull to deck joint bonded with 3M 5200 adhesive sealant



Keel & Ballast

- 9,750 lb., antimonial hardened lead casting
- Template ground for fit and maximum performance
- Faired and epoxy coated
- Keel is thru-bolted to hull with cast in place stainless steel bolts
- Keel bolt quantity and size exceed ABS standard for offshore use

Rudder & Steering System

- Console style rack and pinion steering pedestal
- 48" stainless steel leather wrapped wheel
- Stainless steel pedestal guard
- Single lever engine control with stainless steel handle
- 5" binnacle compass with stainless steel hood
- High density, closed cell foam rudder blade with reinforced skins
- Autoclave cured carbon fiber rudder post with stainless steel bearing sleeves
- Neoprene gator rudder post seal
- Emergency tiller

Tartan 4700 | Specifications & Features

Engine & Mechanical

- 75 hp diesel
- Four blade folding propeller
- Pedestal mount engine panel
- 120 gallon (454 l) fuel tank capacity with remote gauge
- Fuel filter/water separator
- Lead lined engine insulation
- Engine service access front, sides, and aft
- 80-amp output alternator

Electrical

- Batteries: (2) 8D AGM house batteries, (1) size 27 AGM starting battery and (2) Optima bow thruster batteries
- 30 AMP battery charger
- Polished chrome and stainless steel interior lighting
- Automatic lights in hanging lockers, liquor locker and refrigerator compartment
- Service lighting in engine compartment
- Service lighting in cockpit lockers
- Directional reading lights at berths and main cabin settees
- Directional spotlights over main cabin table
- Recessed, dimmable spotlights in cabin overhead
- Interior, cockpit and transom door courtesy lighting
- Dual 30 amp shore power services
- 110 VAC distribution panel prepped to accept gen set
- 12 VDC & 110 VAC digital metered distribution panel
- Battery selector switch
- Electrical bonding system
- Electric sump pump with automatic float switch for icebox and shower drains
- (2) Electric bilge pumps with automatic float switches and manual override
- (2) High water bilge alarms
- UL approved, stranded, tinned copper wiring
- Wiring bundled in PVC conduit with room for future installations
- All wiring chafe protected where it passes through internal structure
- ABYC compliant color coded wiring throughout
- USCG approved navigation lights on bow rail, stern rail and mast

Galley & Plumbing

- 3 burner Force 10 gimbaled LPG stove with oven and broiler
- LPG sniffer with automatic shut off
- Cherry faced cabinetry with raised panel access doors
- Cherry faced, dovetailed cutlery drawers
- 9" deep double sinks with premium marine grade galley faucet and manual foot pump with swivel spigot
- Granicoat solid surface galley countertops
- Storage under galley sink through ventilated raised panel cherry doors
- Galley trash bin
- Split teak cutting board with waste bin under
- Molded icebox with Granicoat solid surface counter top and 4" foam insulation, insulated front and top load access, insulated divider in box
- (2) 12 Volt DC refrigeration units for refrigerator and freezer
- Hot and cold pressure water with service access to pump and plumbing
- Polyethylene tubing and Whale mechanical fittings for freshwater plumbing
- All below waterline hose connections are double clamped with stainless steel hose clamps
- Premium marine grade hoses used throughout
- 200 gallons (757.08 l) of freshwater tankage with distribution manifold
- 11 gallon (42 l) water heater, operates on 110 VAC or engine heat exchanger

Heads

- (2) Marine heads, each with 30 gallon (113 l) holding tank
- Deck pump out with vent
- Low odor premium marine grade sanitation hose
- Separate stall shower in aft head with Plexiglas enclosure, molded seat & molded shower lockers
- Shower drains to separate sump box with automatic overboard discharge
- Hanging/wet locker outboard of aft shower seat
- Premium marine grade head faucets and shower mixers
- Molded Granicoat solid surface counter tops with integral sink
- Utility storage under sink through raised panel cherry door
- Solid cherry face upper vanity cabinet with storage

Tartan 4700 | Specifications & Features

Ventilation

- (9) Stainless steel unlimited offshore CE approved deck hatches
- (8) Cabin side mounted stainless steel opening port lights with fly screens
- (3) Cockpit mounted stainless steel opening port lights with fly screens
- Lexan sliding companionway hatch with fiberglass spray hood, solid teak hatch doors and trim

Accommodations & Storage

- Raised deck salon with laminated safety glass windows provides spaciousness and visibility
- Forward cabin with extensive lockers, hanging locker and thirteen dovetail drawers
- Aft cabin with extensive lockers, hanging locker and four dovetail drawers
- Queen-sized berth in forward and aft cabins with quilted mattress
- Starboard crew cabin with stacked single berths
- Furniture grade main cabin settees and seats with contoured cushions
- Main cabin fit with cherry cabinets and ventilated raised panel doors throughout
- Large storage outboard of main cabin seat backs
- Varnished, drop leaf, solid stock cherry main cabin table with center storage
- Forward-facing navigation station to starboard
- Navigation lockers with installation space for extensive electronics

Interior

- Structural fiberglass timbers bonded to hull to carry mast and keel loads
- Structural bulkheads bonded to hull and deck
- Cherry or pressure laminate faced bulkheads and risers
- Solid stock cherry trim throughout
- Solid stock raised panel cherry passage doors in cherry door jambs
- Polished chrome mortised door lock sets
- Solid stock cherry cabinet faces throughout
- Positive lock polished chrome cabinet hardware
- Solid cherry face, dovetail joined, all wood drawers throughout
- Cherry main salon table with Tartan logo inlay and center storage
- Tongue and groove solid cherry hull ceilings
- Cherry battened overhead with strategically placed access panels
- Varnished Teak and Holly cabin sole with Teak banded access hatches
- Varnished solid teak handrails placed for security in a seaway
- Interior woodwork sprayed with satin finish lacquer varnish
- Selection of designer fabrics, Ultra Leather or Ultra Suede upholstery



Spars & Rigging

Mast:

- Painted Selden Aluminum mast with sheaves for (1) jib, (1) main, (1) reacher and (1) spinnaker halyard
- CCR Rig and self tacking jib
- Tapered airfoil swept spreaders
- Custom designed aluminum masthead with sheaves for 2 headsail halyards, 2 main halyards and spinnaker crane
- 1 x 19 Stainless steel wire rigging with forged turnbuckles
- Internal halyards
- Custom stainless steel chainplate system ties to structural FRP grid and hull
- Harken furler for self-tacking jib
- Halyard winch with rope clutches and horn cleats on mast
- Masthead anchor light
- Steaming light with foredeck illuminator
- Mast wiring conduit
- Spartite mast sealing and chock system
- (2) fold down stainless steel mast steps
- Low friction main sail track system

Boom:

- Painted Selden aluminum boom with stack pack system
- (2) Single line reefs led aft to housetop winch,
- Internal 4:1 outhaul
- Two-part boom topping lift
- Rod vang with tackle led aft

Running Rigging:

- Low stretch main and genoa halyards
- Double ended polyester double braid jib sheet
- Polyester double braid jib sheets
- Double ended polyester double braid mainsheet
- Polyester double braid main traveler control lines
- (2) Polyester double braid reef lines

Sails

- Dacron full batten mainsail
- Dacron 100% self-taking jib

Tartan 4700 | Specifications & Features

Deck Hardware

- (2) Harken 50.2 STC (self tailing chrome) cockpit winches
- (2) Harken 46.2 STC cockpit winches
- (1) Harken 46.2 STC house top winch
- (1) Harken 40.2 STC genoa halyard winch on mast
- Polished stainless steel outboard genoa tracks mounted on toerail
- (3) Harken aluminum winch handles
- Admiral's cup style mainsheet system led aft to mainsheet winches port and starboard
- Harken self tacking jib track with double ended sheet led aft to cockpit winches
- Harken main traveler with tagline adjustment led to aft end of housetop
- Custom stainless steel mast collar with multiple attachments for blocks
- Harken turning blocks at base of mast for aft sail control leads
- Harken over/under style aft lead control blocks
- (6) Spinlock rope clutches for aft sail control leads
- 27" x 1 1/8" diameter stainless steel stanchions
- 27" x 1 1/8" tube double stainless steel bow rail with navigation light
- 27" x 1 1/8" tube double stainless steel split stern rail with navigation light
- 1 x 19 double lifelines with port, starboard, and transom boarding gates
- Custom stainless steel stem fitting with integral double bow rollers
- Custom fabricated bow and midship mooring chocks
- (6) Stainless steel 10" mooring cleats
- Stern stainless steel quarter caps
- 2 3/4" x 2" Teak toerails through-bolted to hull flange
- Teak taffrail
- Companionway hatch sea hood with instrument pod
- Anchor locker lid with latch
- Deck drains to waterline discharge, eliminates hull streaking
- Teak housetop handrails
- Cockpit mounted manual bilge pump
- Drink holders in cockpit
- Offshore ready, match molded, and gasketed cockpit seat hatches
- Walk through transom with hinge down swim platform and ladder

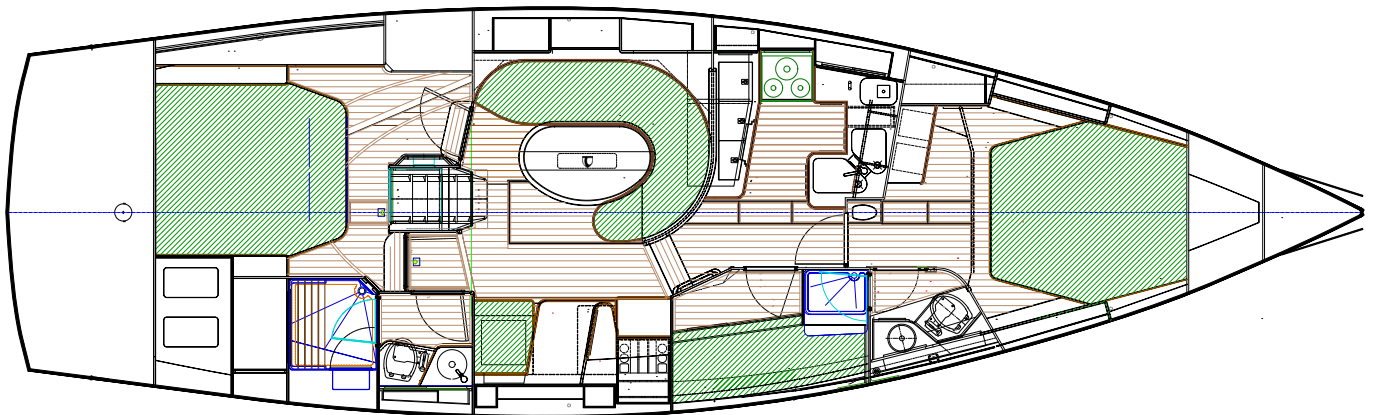

Tartan 4700 | Specifications & Features

Design Dimensions

LOA.....	46.875 ft.
LWL	39.5 ft.
LOA/WL.....	1.19
Max Beam	14.08 ft.
Draft.....	6.25 ft.
Displacement.....	28,000 lbs.(Light Ship)
Ballast.....	9,750 lbs. (All Lead)
Ballast/Disp.....	.35
Disp/Length.....	202.82

Rig Dimensions:

I Self tacking Jib	59.5 ft.
I Reacher	62.7 ft.
J Self tacking Jib	16.5 ft.
J Reacher	17.5 ft.
P	55.5 ft.
E	19.2 ft.
Bridge Clearance (No Electronics)	68.0 ft.

SA/Disp.:

ST Jib 100% Fore Tri.....	17.76
Reacher 100% Fore Tri.....	18.76

Sail Dimensions:

Mainsail.....	532.8 sq. ft.
100% Fore Tri, Self Tacking Jib	490.875 sq. ft.
100 % Fore Tri, Reacher.....	548.625 sq. ft.
Total W/ST 100% Fore Tri.....	1,023.675 sq. ft.
Total W/Reacher 100% Fore Tri.....	1,081.425 sq. ft.
Designer	Tim Jackett
Stix (CE Stability Index)	48
CE approved for category "A" unlimited offshore	

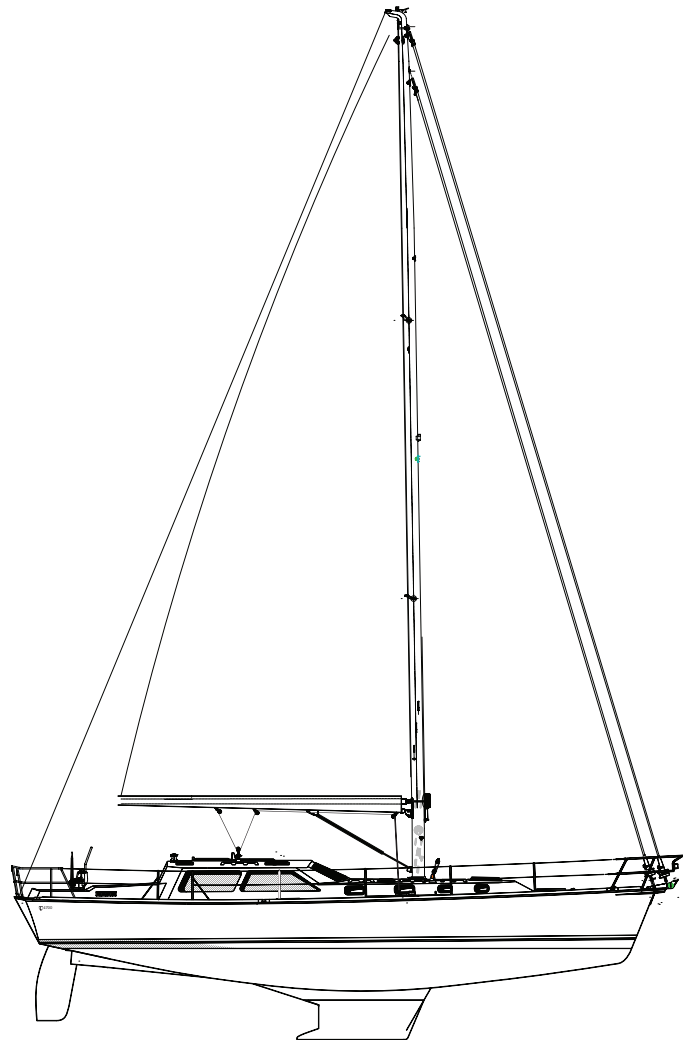

Sophisticated Designs • Exceptional Performance • Superior Value

440-392-2628 • www.tartanyachts.com • Fantail • 101 • 115 • 3400 • 3700 • 4000 • 4300 • 4700 • 5300

© 2015, Tartan Marine Company, All rights reserved. *Specifications subject to change. Updated April 2015.*